

# LONG WHEELBASE SHOGUN FV2440T

MY21 ■ 6x4 ■ SHIFTPILOT

**NEW**  
GENERATION

+ ADVANCED  
SAFETY SYSTEMS

**EURO 6**  
ENGINE +  
TRANSMISSION



**Power / Torque:**  
400ps/2,011Nm



**Wheelbase:**  
6,380mm (T)



**Suspension:**  
Air

- Active Brake Assist 5 **NEW**
- Electronic Stability Control
- Lane Departure Warning

- Adaptive Cruise Control
- Driver Fatigue Monitoring
- Active Side Guard Assist **NEW**

# SPECIFICATIONS - SHOGUN FV2440T 6x4

## MODEL

6x4 FV2440T 12 SP. SHIFTPILOT AIR SUSP. FV74HT2VFBA

## WHEELBASE (mm)

6,380 (T)

## GVM (kg)

24,000

## GCM (kg)

53,000

**EURO 6**  
**ENGINE +**  
**TRANSMISSION**

## ENGINE

Engine Version	FUSO OM470 6 Cyl. In-line DOHC
Displacement	11 Litre (10,671cc)
Power (DIN)*	400ps (293kW) @ 1600rpm
Torque (DIN)*	2,011Nm (1484lbft) @ 1100rpm
Air Cleaner	Vertical Intake Mounted on Clean Air Side (RH)
Emission Control	Selective Catalytic Reduction (SCR + DPF)
Emission Level	EURO 6 (ADR80/03)

\*Gross Calculated

## OM470 – T2

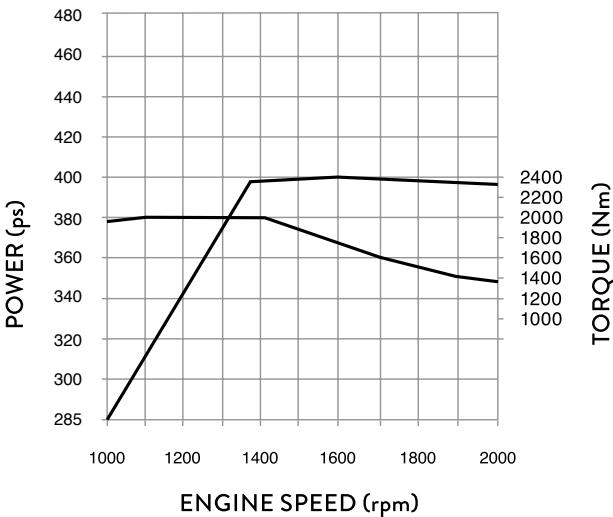

## FUEL

Injection System	X Pulse Common Rail High Pressure Direct Injection
Tank	400L Rectangular Alloy Tank + Locking Cap
AdBlue Exhaust Fluid Capacity	60L Tank + Locking Cap

## ELECTRICAL

Voltage	24V Negative Ground, 100A Alternator
Battery Specification	Heavy Duty 2x12V, 150Ah / 20hr

## CLUTCH

Type	FUSO Single Plate Fully Automated
------	-----------------------------------

## TRANSMISSION

Version	FUSO SHIFTPILOT GENERATION 3 Automated Manual G230-12
Type / Speeds	12 Speed with Auto + Manual Modes Constant Mesh Non Synchromesh Transmission

## TRANSMISSION CONTINUED

Features	Standard + Economy Modes: Calibrated for NZ Conditions Driver Activated Kick Down Skip Shift Function for Light Loads Crawler Mode Rock-Free Mode Eco Roll Eco Cruise	
Ratios	1st: 11.672 2nd: 9.101 3rd: 7.055 4th: 5.501 5th: 4.400 6th: 3.430 7th: 2.652	8th: 2.068 9th: 1.603 10th: 1.250 11th: 1.000 12th: 0.779 RHigh: 9.101 RLow: 11.673
PTO Opening	Rear	

## FRONT AXLE

Axle Version	FUSO F900T "I" Beam
Max Operating Capacity (kg)	7,100 (Subject to suitable tyres + certification)

## FRONT SUSPENSION

Type	Long Taper Leaf + Double Acting Shock Absorbers
Size (mm)	1,500 x 90

## REAR AXLE

Axle	D10 Hypoid Tandem Drive with Inter-Axle Diff Lock
Max Operating Capacity (kg)	21,600
Ratio	4.222:1

## REAR SUSPENSION

Details	Air Trailing Arm + 2 Bag / Axle Height Control (adjustable from steering wheel or remote control)
---------	---

## BRAKES

Type	Full Air Taper Roller Drum Brakes + Auto Adjust, EBS, ABS, ASR (Traction Control)
Size Front / Rear (mm)	410x160 / 410x200
Park Brake	Rear Wheels Spring Actuated
Engine Brake	Jake Brake: Three-Stage including Shift Down Function – Max 335kW (460ps)
Air Compressor	Two-Stage + ECU Control for Fuel Saving
Air tanks	Alloy

## WHEELS AND TYRES

Wheels	10 x Alcoa Alloy 22.5 x 8.25" ISO 10 Stud
Tyre Size Front / Rear	275/70R22.5

ADVANCED  
SAFETY  
SYSTEMS

Type	Super Frame, Single Skin, Reinforced Parallel Channel
Size / Width (mm)	300x90x7.0 / 840
Refer to the bodybuilders guidelines on the Fuso website ( <a href="http://www.fuso.co.nz">www.fuso.co.nz</a> ) before mounting a body or modifying the chassis	

<b>Gauges</b>	Speedo / Tacho / Air pressure / Fuel level / Ad Blue level
<b>Multi-Information Display accessed from steering wheel buttons</b>	Digital Speedo Advanced Safety Systems Control Water Temperature Fuel Consumption Warning Lamps Service Indicators Hour Meter + Tripmeter Oil Level Check Alarm Clock
<b>Steering wheel controls</b>	Audio / Phone / Cruise Control / Multi-Information Display Menu / Speed Limiter

<b>Cab Cooling and Heating</b>	Climate Control Air Conditioning
<b>Accessory Power</b>	24V Accessory Power Outlet x 2
<b>Driving</b>	SMART Key Push Button Start + Keyless Central Locking Electric Windows Fluorescent Cabin Lamp Interior Reading Lamps Engine Idle Speed Control

Type	Low Floor All Steel 4 Point Air Suspended + Electric / Hydraulic Tilt Cab
Colour	Natural White (W31)
Seating Capacity	2 + Large Centre Console
Seat (driver)	Air Suspension Integrated Seat Belt Auto Levelling Height, Tilt, Lumbar + Dampening Adjust Armrest
Seats (passenger)	Bucket Seat with Integral Headrest
Interior	Fully Trimmed with Heavy Duty Vinyl on Floor Premium Rear Bunk Mattress + Curtains
External	Roof Mounting Points (max. static load 50kg) Front End-Outline Marker Lamps

**60,000km full service / 15,000km safety inspection**  
60,000km full service intervals, depending on application/use. 15,000km safety inspection, with greasing, required for reliability and to maintain warranty cover.

**5 years / 500,000km**  
Simply have your vehicle serviced at an authorised FUSO Service Centre, at the recommended servicing intervals, and you are covered by an additional 2 year / 250,000km FUSO warranty on top of the first 3 years / 250,000km. That's a total of 5 years / 500,000km cover! Refer to the terms and conditions in the FUSO warranty booklet for full details.

Electronic Brake System (EBS)	Yes	
Electronic Stability Control (ESC)	Yes	
Active Brake Assist (ABA5)	Yes	NEW
Lane Departure Warning System (LDWS)	Yes	
Active Attention Assist (Driver Fatigue Monitoring)	Yes	
Proximity Control Assist (Adaptive Cruise Control)	Yes	
Active Side Guard Assist (ASGA)	Yes	NEW

Structure	ECE-R29 European Cab Strength (max front axle weight 6.5T) Door Side Impact Beams
Airbags	Driver (steering wheel)
Seatbelts	Pre-tensioner, Integrated with seat (driver), Warning Light (driver)
Front Underrun Protector Beam (FUP)	Yes
LH Transom Window + Rear Quarter Glass	Yes
Steering Wheel	Leather, Tilt / Telescopic Adjustable
Rearview Mirrors	Remote Control, Heated + Separate Convex Spotter (both sides)
Auto-sensing Headlamps	Auto High/Low Beam Activation Xtra Vision LED (low beam) Halogen (high beam) Manual height adjustment
Day Time Running Lights	Yes
Fog Lamps	Yes
Front Step Lights	Yes
Keyless Central Locking	Yes
Auto-sensing Wipers	Yes
Trailer Brake Control Lever	Yes
7" Touchscreen Media Unit	AM/FM/DAB + USB + AUX Apple CarPlay + Android Auto Wi-Fi enabled for Internet Radio Bluetooth, 32GB capacity storage HD Reverse Camera included †

<b>Speed Limiter</b>	Yes (100km/h factory setting)
<b>Jake Engine Brake (460ps)</b>	Yes
<b>Anti-Lock Braking System (ABS)</b>	Yes
<b>Brake Override System</b>	Yes
<b>Hill Start System</b>	Yes
<b>Traction Control (ASR)</b>	Yes
<b>Interaxle Diff Lock</b>	Yes
<b>Emergency Stop Signal (ESS)</b>	Yes
<b>Reverse Warning Buzzer</b>	Yes

## † Additional Touchscreen Display Cameras (up to 4) / Truck Specific GPS Navigation / Reversing Sensors / Tyre Pressure Monitoring (up to 36 tyres)

		Vehicle Ratings**		Max Axle Loadings**		Kerb Weights*		
Model		GVM	GCM	Front***	Rear	Front	Rear	Total
6x4 FV2440T 12 Sp. SHIFTPILOT Air Susp.	FV74HT2VFBA	24,000	53,000	7,100	21,600	4,495	3,235	7,730
* Weights (est.) includes 10L fuel and are subject to 3.5% variation (+/-)		** Vehicle ratings and max axle loadings may be limited by local regulations.						
*** Subject to suitable tyres and certification								

# SPECIFICATIONS - SHOGUN FV2440T 6x4

## PERFORMANCE

Turning Circle (kerb to kerb - metres)	21.2
Electronically Speed limited to 100km/hr	Can be adjusted lower by dealer
Engine Speed (rpm) 90km/hr (top gear)	1,700
Gradeability at Rated GCM (theoretical)*	25%

\*This is theoretical performance only. Actual performance may vary under different conditions

## DIMENSIONS (mm)

Wheelbase	6,380
Length Overall	11,320
Height Overall	3,175
Width Overall	2,490
Width Rear Axle	2,475
Width Front track	2,075
Width Rear Track	1,865
Width Frame	840
Height Frame at Rear Axle (Air Susp. inflated)	980

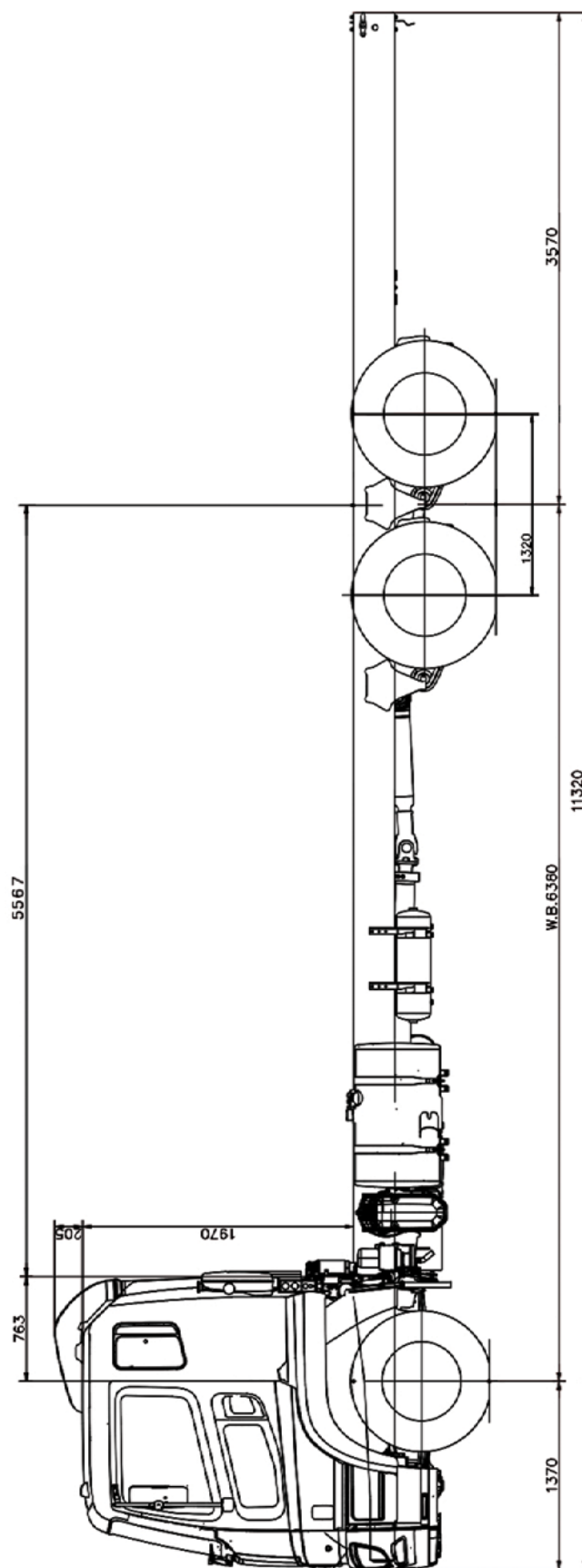

6x4 SHOGUN FV2440T LWB – 'T' WHEELBASE

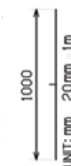

Scale = 1:50 (20mm = 1 metre). This scale is accurate when used on the original spec sheet, be aware that enlarging these illustrations can alter the scale and cause incorrect measurements. Fuso New Zealand and its authorised dealers always recommend customers seek professional advice from independent sources before commencing any engineering activities.

A policy of continual improvement means that specifications detailed in this brochure are subject to change without notice. Contact your authorised Fuso dealer to confirm current specifications. Fuso is a registered trademark of Mitsubishi Fuso Truck & Bus Corporation. Copyright © Fuso NZ Ltd (2021).